

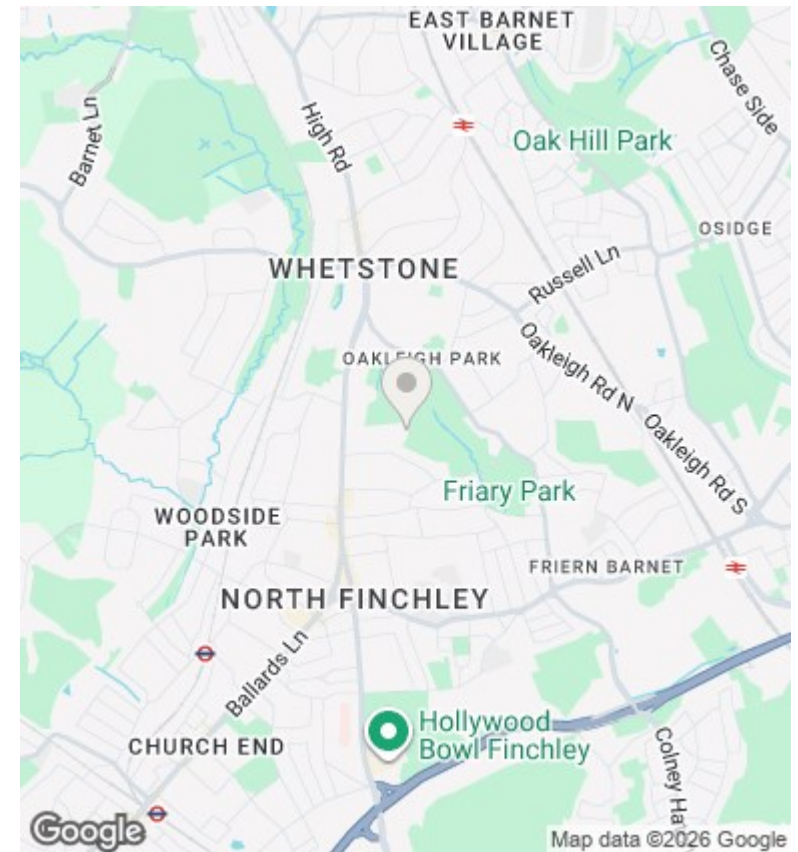

Finchley Park, London, N12 9JR

£1,500 Per Calendar Month

- Recently redecorated one-bedroom ground floor purpose-built apartment
- Private paved front garden
- Fitted kitchen with appliances
- Available NOW
- Located in a quiet residential turning
- Close to local shops, cafés, restaurants and everyday amenities
- Council tax band B
- Deposit £1730
- Convenient for Woodside Park Underground Station (Northern Line)
- Part - Furnished

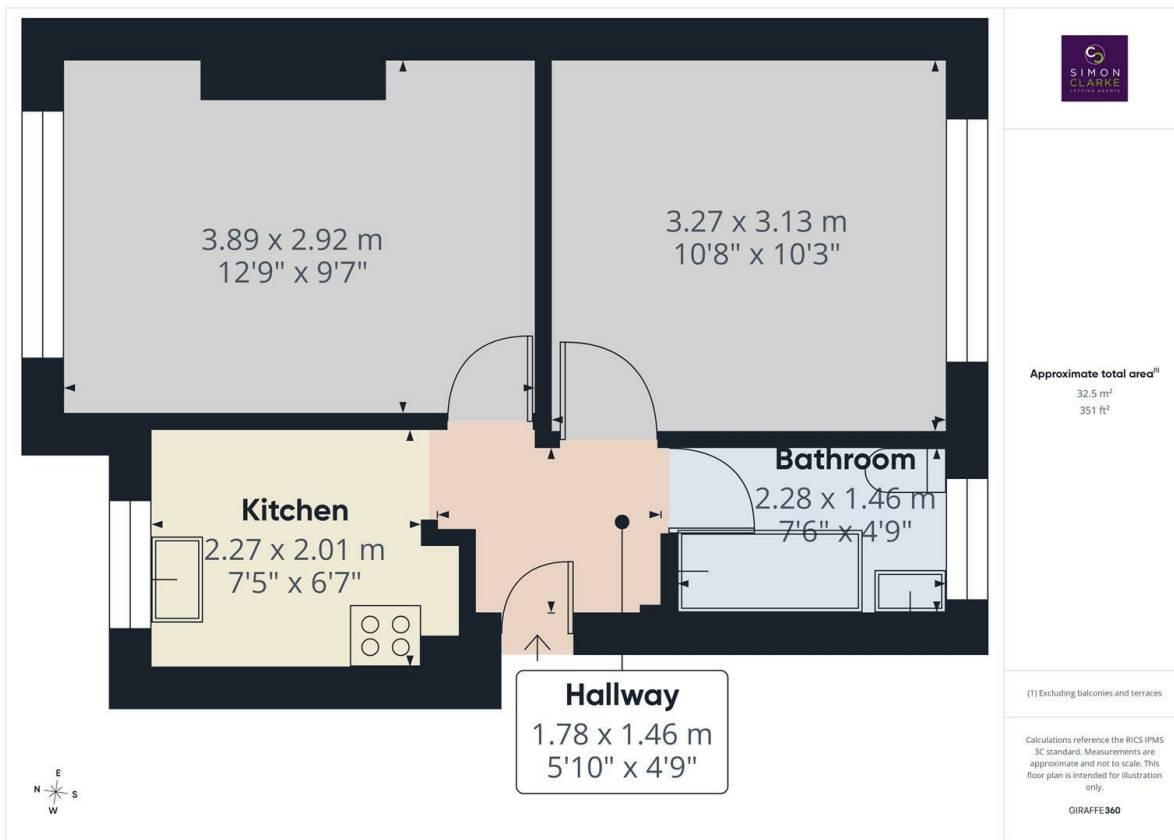

## Directions

## Viewings

Viewings by arrangement only. Call 02083499000 to make an appointment.

## Council Tax Band

B

## EPC Rating:

C

